

Site Evaluation and Solution Design

FCB *id*, a member of the FC Background, LLC family, offers turn-key systems integration capabilities leveraging AIDC applications that provide asset tracking and management solutions enabling companies to tag, track and instantly locate assets, contents and component parts across the entire supply chain enterprise.

Our Site Evaluation & Design Services are critical to the success of any application integration effort. It allows us to demonstrate how the technology will work within your environment and confirms the solution requirements. Our clients receive peace of mind and confidence in knowing that we understand their requirements, concerns and solution aspects to ensure project success.

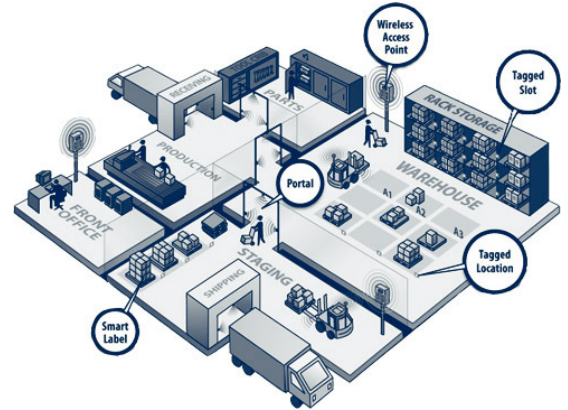

Onsite solution design, media placement and technology validation require expert skills?

Site Evaluation Services

Mitigating procurement risks and knowing which technology will actually work in your environment is one of the most important aspects of technology selection. We provide our clients with a service that supplies the necessary testing equipment, labor and expertise to determine environmental factors, configuration settings and risks (if any) prior to any pilot or production deployment. This service minimizes the initial capital investments normally associated with a technology purchase and validates product selection methods, performance and key areas of concern.

We conduct this service by the following:

- Provide a sampling of product to be purchased
- Determine asset's process flow
- Denote the RF environmental concerns
- Analyze LAN, WLAN and WAN requirements
- Understand the asset characteristics to include packaging
- Recommend the Solution Design & B.O.M.

Media Placement Validation

Media placement is a key requirement for any AIDC technology deployment to ensure solution success. In today's economic climate customers have just in time inventories, heavy shipping costs and do not have the labor to ensure solution media placement testing prior to implementation. Our analysts have spent years analyzing media placement to understand the negative and positive location to increase performance and reduce business system impacts.



Sample media testing configuration pallet

FCB *id* accomplishes this level of service via the following:

- Providing a sampling of the various media
- Work with our clients on testing scripts to ensure data validation in accordance with asset or product packaging
- Conduct placement testing of media on actual assets
- Record the testing results and confirm solution conformance with facility standards.

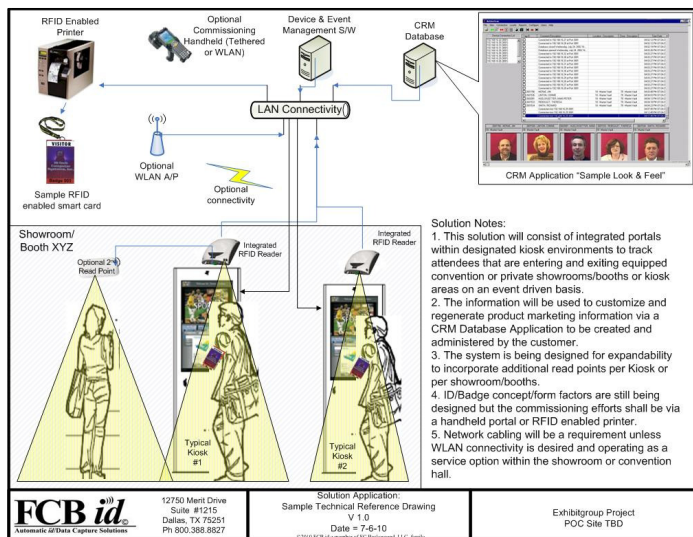

Sample System Solution Design

FCB *id*
Automatic *id*/Data Capture Solutions

Proof of Concept Testing

Lab testing is a great concept if the environment is well controlled, documented and does not change when it comes to selecting technology components to be embedded within a specific solution. Radio Frequency (RF) based technologies have further challenges in that they emit and receive radio signals that are affected by environments and other systems within close proximity leaving metric impact challenges. Live testing within a facility's environment is more practical when it comes to ascertaining the predictive performance characteristics for a desired solution. Our analysts are certified and well trained in utilizing a unique approach to concept testing by leveraging previous testing results of similar environments with key metric results from lab tests.

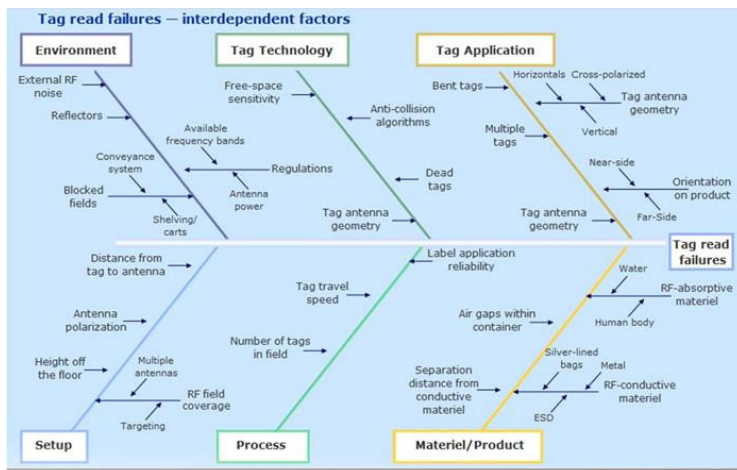

In addition to published lab results, we utilize other key tools to provide a realistic view of how the solution will ultimately perform within your facility. Those other key tools consist of:

- Technology Performance Charting
- Media Performance Comparison Validation
- RF Spectrum Environmental Analysis Metering
- Configuration Testing Documentation

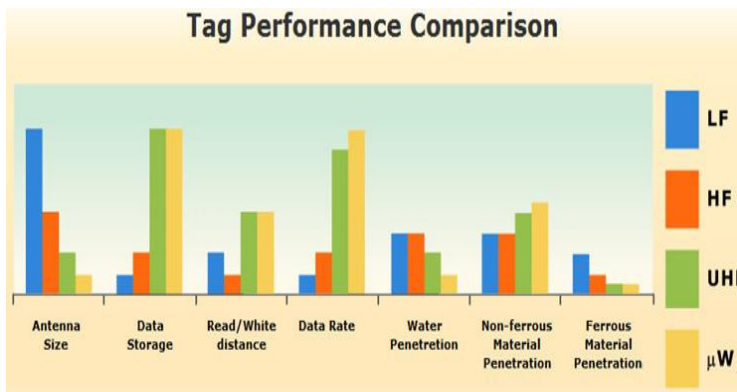

Making Applications a Reality

In addition to Proof of Concept detailed testing, we help our clients determine how best to apply certain technologies throughout the enterprise. We achieve this by providing project scoping, business process consulting, system design documentation, and hardware/software installation support.

FCB *id* provides:

- A sales process that partners with you
- Presales engineering to determine best options
- Project management to ensure accuracy
- Complete solution design that encompasses full system integration
- Post maintenance support that ensures system performance after integration completion.

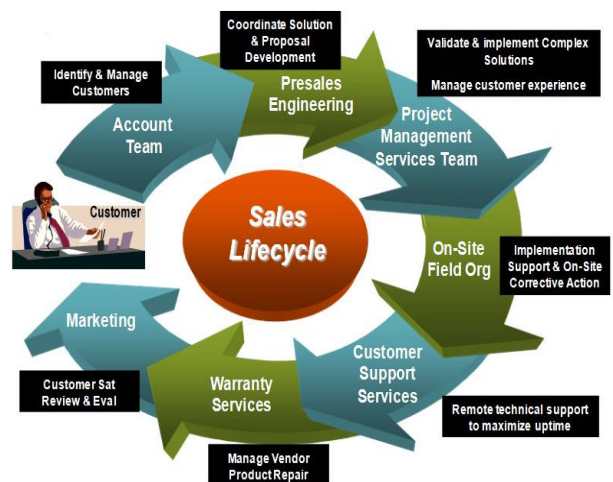

Proven People, Proven Experience

FCB *id* is not only factory trained, but also CompTIA certified in AIDC and RFID technologies. CompTIA is the world's leading association representing the international technology community that works to advance industry growth through standards, professional competence, education and business solutions.

FCB *id*'s team starts by gaining an understanding of your specific environment and requirements. After achieving this baseline, the next step is collaborating with your RFID team to develop a set of mutually agreed upon objectives and milestones specific to each individual project. Working with the on-site RFID team ensures a project success.

FCB *id*
Automatic *id*/Data Capture Solutions

www.fcbackground.com
12750 Merit Drive Suite #1215
Dallas, Texas 75251

For Further Info:
Phone: 800.388.8827
Fax: 972.404.4415